

SECTION A-A

ITEM NO.	MATERIAL	DESCRIPTION	QTY.
1	SiC	ROTARY INSERT	1
2	316L	ROTARY COLLAR	1
3	CBN/H.T. CBN/TUNG-CAR/SiC	STATIONARY INSERT	1
4	316L	STATIONARY RETAINER	1
5	17-7PH/H-276	WAVE SPRING	1
7	AFLAS/KALREZ/EPR/SILICONE/VITON	STD O-RING	1
8	AFLAS/KALREZ/EPR/SILICONE/VITON	STD O-RING	1
9	AFLAS/KALREZ/EPR/SILICONE/VITON	STD O-RING	1
10	AFLAS/KALREZ/EPR/SILICONE/VITON	STD O-RING	1
11	AFLAS/KALREZ/EPR/SILICONE/VITON	STD O-RING	1
12	316L/17-4 H900	ZA Back-Plate	1
13	316L	GLAND	1
14	ALUMINUM	CLIP	3
15	302SS	RETAINING RING	1

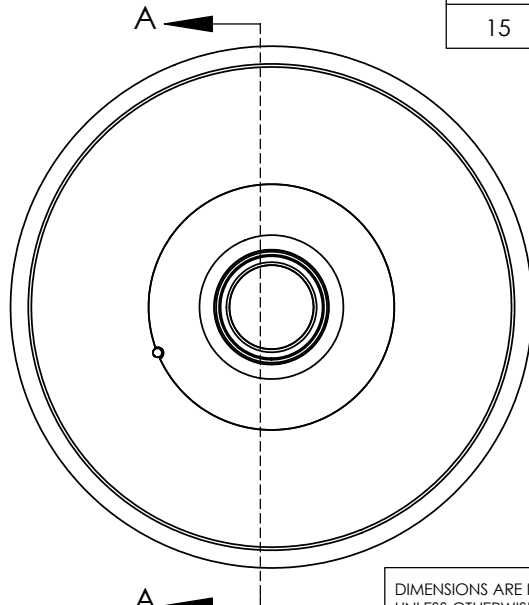

PERFORMANCE

VELOCITY-FPM	T.I. RUNOUT	⊥ TOLERANCE
UP TO 400	.250	.125
UP TO 800	.125	.062
UP TO 1200	.050	.025
UP TO 3000	.025	.015

MAXIMUM PRESSURE - 400 PSI  
 MAXIMUM VELOCITY - 3500 FPM  
 CONSULT FACTORY FOR EXTREME APPLICATIONS

**PROPRIETARY AND CONFIDENTIAL**  
 THE INFORMATION CONTAINED IN THIS DRAWING IS THE SOLE PROPERTY OF ZMT, INC. ANY REPRODUCTION IN PART OR AS A WHOLE WITHOUT THE WRITTEN PERMISSION OF ZMT, INC. IS PROHIBITED.

DIMENSIONS ARE IN INCHES UNLESS OTHERWISE SHOWN		NAME	DATE
TWO PLACE DECIMAL ±.01			1/6/2008
THREE PLACE DECIMAL ±.005		CHECKED	
BREAK ALL CORNERS .010		ENG APPR.	
FACES CONCENTRIC & PARALLEL ±.002		MFG APPR.	
MATERIAL		Q.A.	
SiC/316SS		DESCRIPTION:	
FINISH		ZA CARTRIDGE SEAL	
DO NOT SCALE DRAWING		SIZE	DWG. NO.
		A	ZA MATERIALS
		SCALE:1:8	WEIGHT:
		SHEET OF	

**ZM Technologies**

**ZM Technologies**

SIZE **A** DWG. NO. **ZA MATERIALS** REV.

SCALE:1:8 WEIGHT: SHEET OF