

**EC/ECH PUMPS w/ DOUBLE SEAL
ZC/ZCH PUMPS**

1¹/₂x1¹/₄, 2x1¹/₂, 2¹/₂x2, 3x2¹/₂, 4x3

**AMPCO PUMPS COMPANY
PARTS BREAKDOWN**

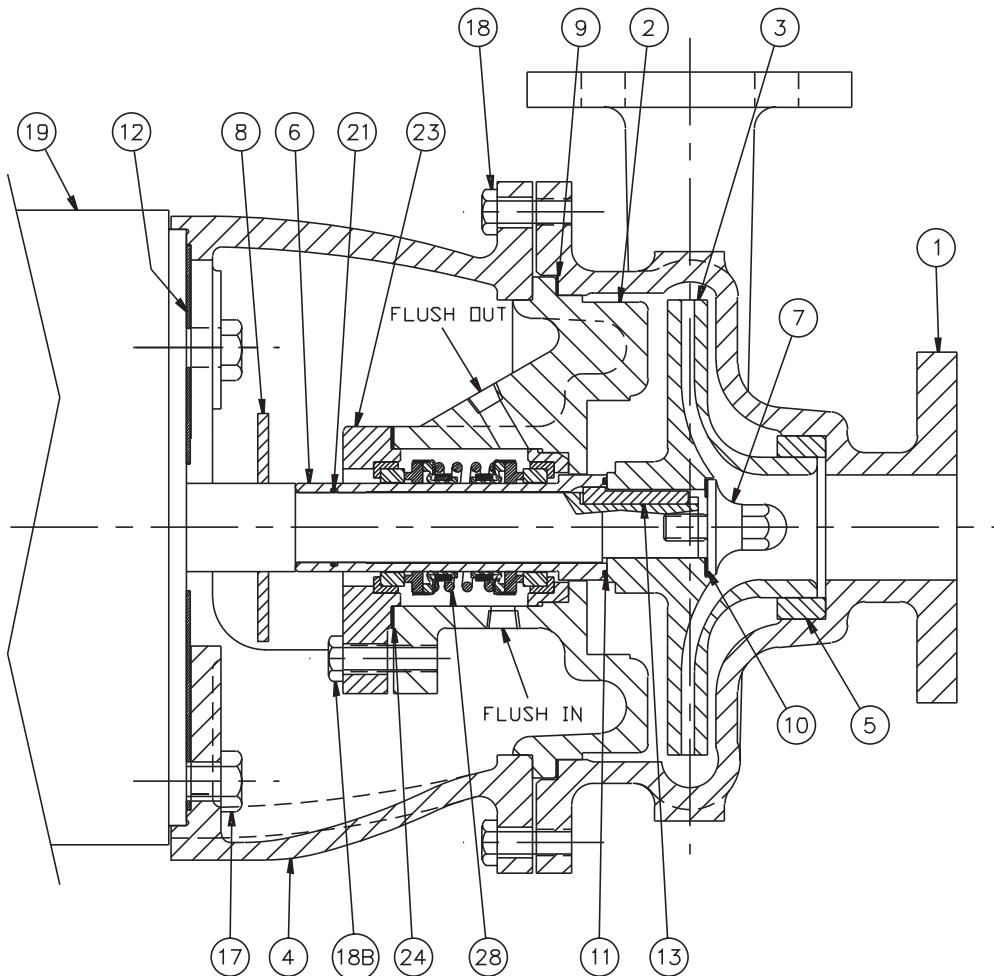

DETAIL NO.	REQ. NO.	PART NAME
28	1	DOUBLE MECHANICAL SEAL
24	1	GLAND GASKET
23	1	GLAND
22 ^{1,2}	1	WEAR RING (COVER)
21	1	O-RING (SHAFT/SLEEVE)
20 ¹	2	PIPE PLUG (OPTIONAL)
19	1	MOTOR
18B	2	CAP SCREW (COVER/GLAND)
18	8	CAP SCREW (CASING/ADAPTER)
17	4	CAP SCREW (MOTOR/ADAPTER)
16 ¹	2	DRIVE SCREW
15 ¹	1	NAME PLATE
13	1	IMPELLER KEY
12	1	SPLASH PLATE
11	1	GASKET or O-RING (SLEEVE/IMPELLER)
10	1	GASKET or O-RING (IMPELLER SCREW)
9	1	GASKET (CASING/COVER)
8	1	SLINGER
7	1	IMPELLER SCREW
6	1	SHAFT SLEEVE
5	1	WEAR RING (SUCTION)
4	1	ADAPTER
3	1	IMPELLER
2	1	COVER
1	1	CASING

¹NOT SHOWN

²ONLY ON 4x3

NOTE: Please be sure to always include pump type, size, and serial number with any reference to above numbers and names.